

NETGEAR®



Powerline 500 PassThru Adapter (XAVB5401) Installation Guide



Contents

Package Contents	3
Hardware Features	4
LED Descriptions	5
Button Descriptions	6
Install Your Powerline Adapters.....	7
Compatible NETGEAR Powerline Devices	11
Safety Information	12

Package Contents

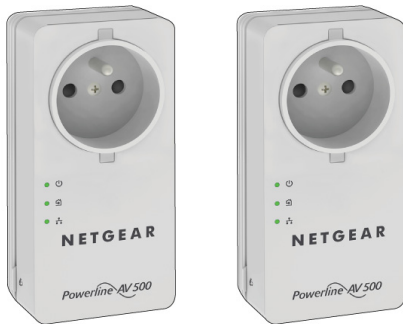

Powerline adapters (2)



Ethernet cables (2)

Adapters vary by region. Your adapter might look different.

Hardware Features

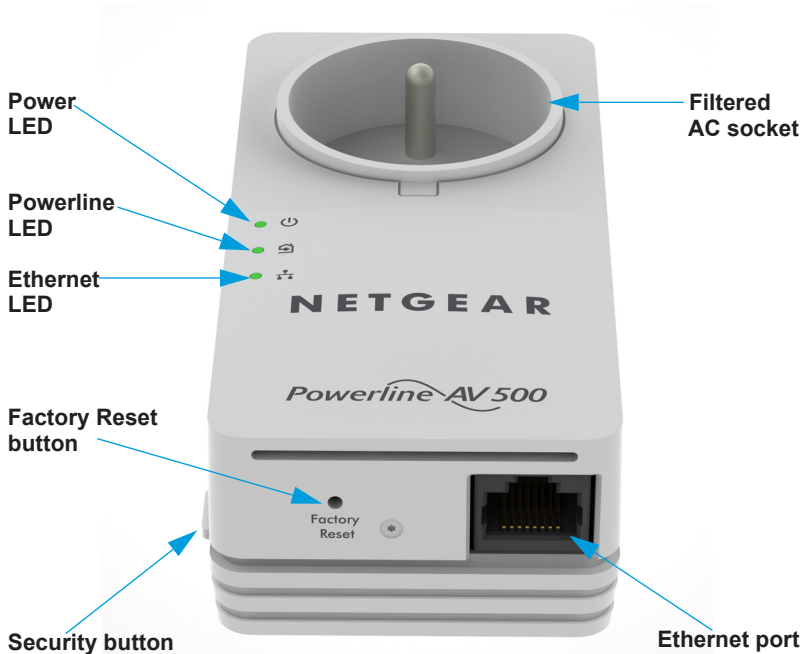

LED Descriptions



The LEDs indicate the status of your Powerline adapters.

- When you plug in the adapter, the Power LED  lights and turns green.

If the Ethernet port is inactive for more than 10 minutes, the adapter enters power saving mode and the Power LED turns amber. Power saving mode is disabled by default.

- The Ethernet LED  lights and turns green when you connect a powered-on Ethernet device to the adapter's Ethernet port. If the Ethernet LED is off, there is no Ethernet connection.
- The Powerline LED lights when the adapter detects at least one other compatible Powerline device.

The Pick A Plug features lets you pick the electrical outlet with the fastest link rate:

-  Green: Link rate > 80 Mbps (fast)
-  Amber: Link rate > 50 and < 80 Mbps (medium)
-  Red: Link rate < 50 Mbps (slow)

Button Descriptions

The buttons on your Powerline adapters let you do the following:

- **Factory Reset button.** To return your Powerline adapter to its default factory settings, press the **Factory Reset** button for 2 seconds, and then release it.
- **Security button.** Use the Security button to secure your Powerline network. For information about securing your Powerline network, see *step 2* on page 7. NETGEAR recommends that you secure your Powerline network to protect your personal information and media from unwanted access.

Install Your Powerline Adapters

1. Plug each Powerline adapter into a wall outlet.
2. Secure your Powerline network.
 - a Make sure that the Power LED is solid green on each Powerline adapter.
 - b On the first Powerline adapter, press the **Security** button for 2 seconds, and then release the button. The Power LED blinks green while the adapter is setting up security.
 - c Within 2 minutes, go to the second Powerline adapter and press its **Security** button for 2 seconds, and then release the button.



After a few seconds, the security is set and the Power LED turns solid green. The Powerline adapters can communicate over the Powerline network in a secure way.

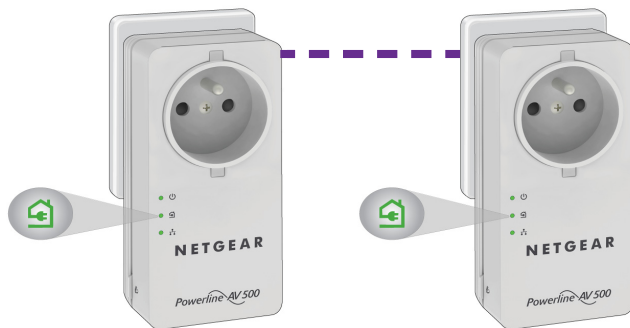

Warning: Do not press the **Security** button until the Power LED on each adapter is solid green. Pressing this button too soon can temporarily disable Powerline communication. If Powerline communication is disabled, use the **Factory Reset** button to return the Powerline adapter to its factory settings.

3. Plug one of the Powerline adapters into a wall outlet near your router or gateway.
4. Connect the Powerline adapter to the LAN port of the router or gateway using an Ethernet cable.

Room A

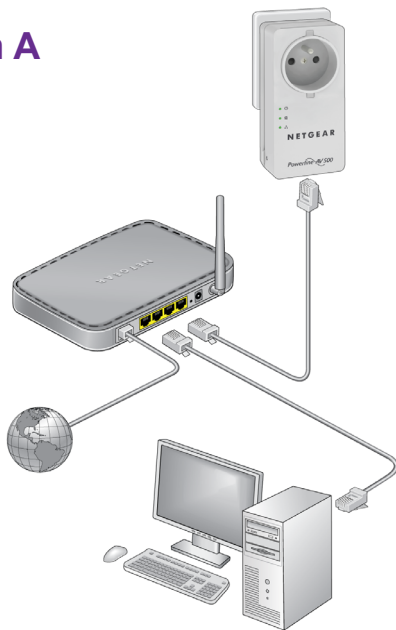

5. Plug the other Powerline adapter into a wall outlet where you want to add Internet access.
6. Connect the second Powerline adapter to an Ethernet-based device using an Ethernet cable.

Room B

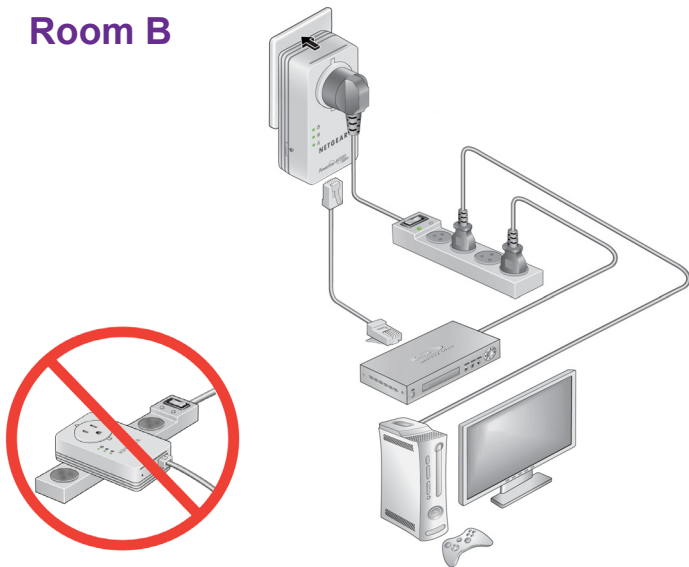

Your Ethernet-based device (computer, game console, set-top box, or Blu-ray player) now has Internet access.

Compatible NETGEAR Powerline Devices

Your Powerline devices can share a Powerline network with these compatible NETGEAR devices: XAVB1301, XAVB1401, XAVB2101, XAVB2602, XAVNB2001, XAVB5601, XAVB5101, XAVB5201, XAVB5602, XAUB2511, XAVB5004, XAVB1004, XWNB5602, XWNB5201, and XWNB1601.

For a complete list of HomePlug AV-certified devices, visit www.homeplug.org/certified_products.

Safety Information

- For national approvals (approval schemes other than CB), relevant national standards for plug, socket-outlet, and direct plug-in units (for example, US) shall also be consulted while testing and approving such products according to national standards.
- AC input rating (NA): 100–125V, 0.2A (Max); 50–60 Hz excluding socket outlet rating.
- AC input rating (AU, UK, FR, EU): 200–250V, 0.2A (Max), 50–60 Hz excluding socket outlet rating.
- XAV5401 ratings (maximum load): EU: 16A, 250V; UK: 13A, 250V; FR: 16A, 250V; NA: 15A, 125V; AU: 10A, 250V.
- Operating temperature: 0–40°C.
- Check the electrical current for any device plugged into the filtered AC socket. Do not exceed home and product outlet ratings and electrical requirements.
- The socket-outlet shall be installed near the equipment and be easily accessible.
- Only power cords are allowed to be inserted into the filtered AC outlet; no other equipment with a direct plug-in is allowed. Power

cord needs to be a maximum of 1 m long and a minimum of 0.75 mm square of cross-sectional area.

- Do not plug devices that exceed the product ratings into the XAV5401 filtered AC outlet. The output voltage of the filtered AC outlet is the same as the power outlet that the XAV5401 is plugged into. To help avoid damaging your system, be sure that the attached devices are electrically rated to operate with the power available in your location.
- If the input AC voltage is less than 100 Vac, the device plugged into the filtered AC socket of the XAV5401 might not perform as well as expected.
- **DO NOT PLUG MAJOR HOME APPLIANCES** into the filtered AC socket or into an attached power strip. The device is not intended to be used with home appliances such as air conditioners, power tools, space heaters, fans, hair dryers, ovens, or refrigerators.

Support

Thank you for purchasing this NETGEAR product. After installing your device, locate the serial number on the label of your product and use it to register your product at <https://my.netgear.com>.

You must register your product before you can use NETGEAR telephone support. NETGEAR recommends registering your product through the NETGEAR website.

For product updates, additional documentation, and support, visit <http://support.netgear.com>. NETGEAR recommends that you use only the official NETGEAR support resources. You can get the user manual online at <http://downloadcenter.netgear.com> or through a link in the product's user interface.

Trademarks

NETGEAR, the NETGEAR logo, and Connect with Innovation are trademarks and/or registered trademarks of NETGEAR, Inc. and/or its subsidiaries in the United States and/or other countries. Information is subject to change without notice. © NETGEAR, Inc. All rights reserved.

Compliance

For the current EU Declaration of Conformity, visit:
http://support.netgear.com/app/answers/detail/a_id/11621/.

For indoor use only. Valid in all EU member states, EFTA states, and Switzerland.

NETGEAR, Inc.

350 East Plumeria Drive
San Jose, CA 95134, USA



201-17254-01

April 2013